

MODEL U-4621

Moment Resistance† Variable from 10 to 90 psi (0.68 to 6.2 bar)	260 -1,736 in-lb 29 -196 Nm	Repeatability (about z axis) Measured at center and O.D. of tool plate	±0.017 deg
Torque Resistance† Variable from 10 to 90 psi (0.68 to 6.2 bar)	231 -1,766 in-lb 26 -200 Nm	Mass	5 lb 2.27 kg
Force Resistance† Variable from 10 to 90 psi (0.68 to 6.2 bar)	97 -762 lbf 432 -3,390 N	Height	3.10 in 78.7 mm
Angular Compliance	±8 deg ±0.14 rad	Diameter	5.91 in 150.2 mm
Rotary Compliance	±24 deg ±0.42 rad	Pre-Trip Compliance Range of Adjustability	0 to 0.100 in 0 to 2.54 mm
Axial Compliance Compression	0.55 in 14.0 mm	Temperature Rating	-30° to 210°F -34° to 99°C
Repeatability (x, y & z) Measured at center and O.D. of tool plate	±0.0005 in ±0.0127 mm	Sensor	10 -30 VDC 200mA normally closed switch
		Response Time	4 -10 ms

†Resistance at the factory setting of 0.025" (0.64 mm) compliance. Resistance increases slightly as the pre-trip compliance is increased.

NOTE: The U-4621 must be electrically isolated from the robot when the tooling below it has a voltage potential.

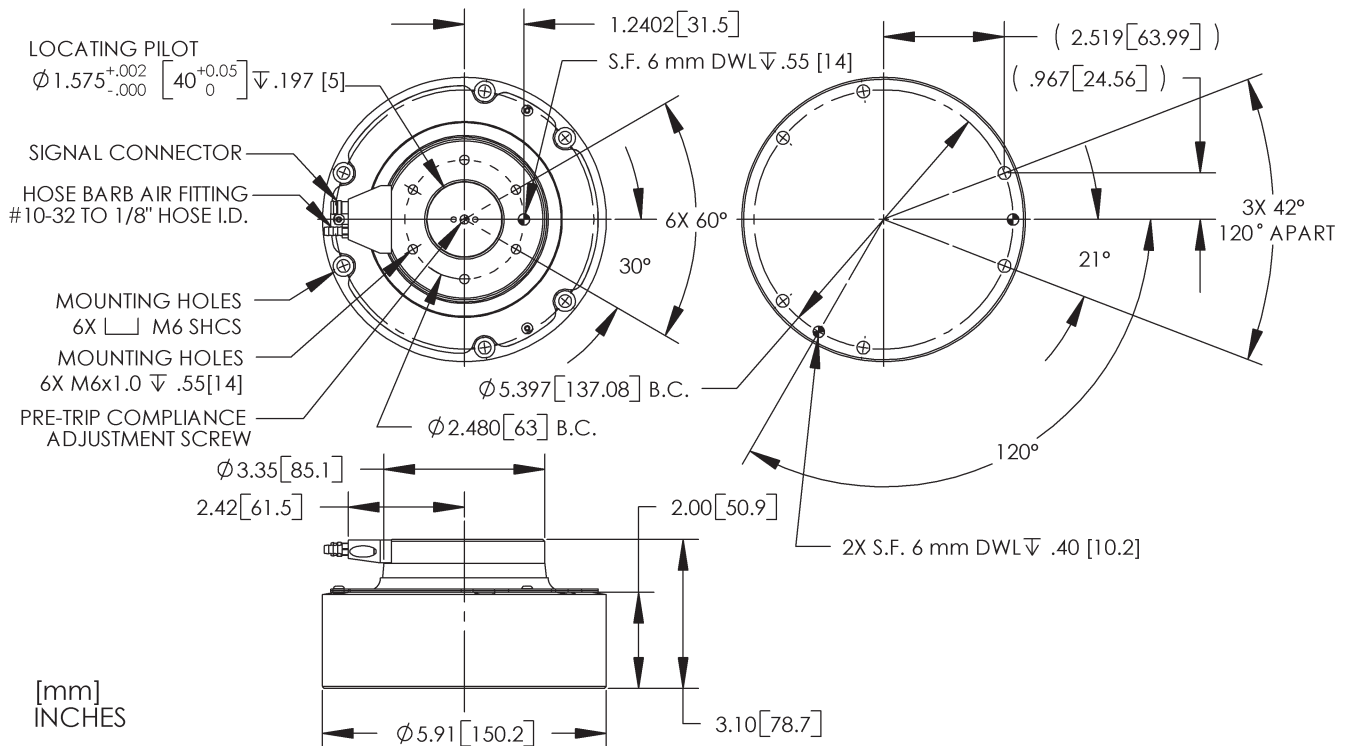

Visit www.rad-ra.com for the most up-to-date product information, 2D and 3D CAD files, and more!