

MODEL 1822 Pneumatic

Specifications

Unit Weight 23 lbs.
 Maximum Lateral Misalignment ±0.10 in.
 Maximum Rotary Misalignment..... ±5°

Model #	Unit Horizontal		Unit Vertical	
	Max Payload lb	Torsional Resistance in-lb	Max Payload lb	Torsional Resistance in-lb
1822 ZR @90 psi	381.7	606.0	99.2	157.6

To find Total Payload:

SL = Static Payload = Mass of all tooling & parts
 DL = Dynamic Payload = Max. Accel/Decel (G's) x SL
 TL = Total Payload = SL + DL

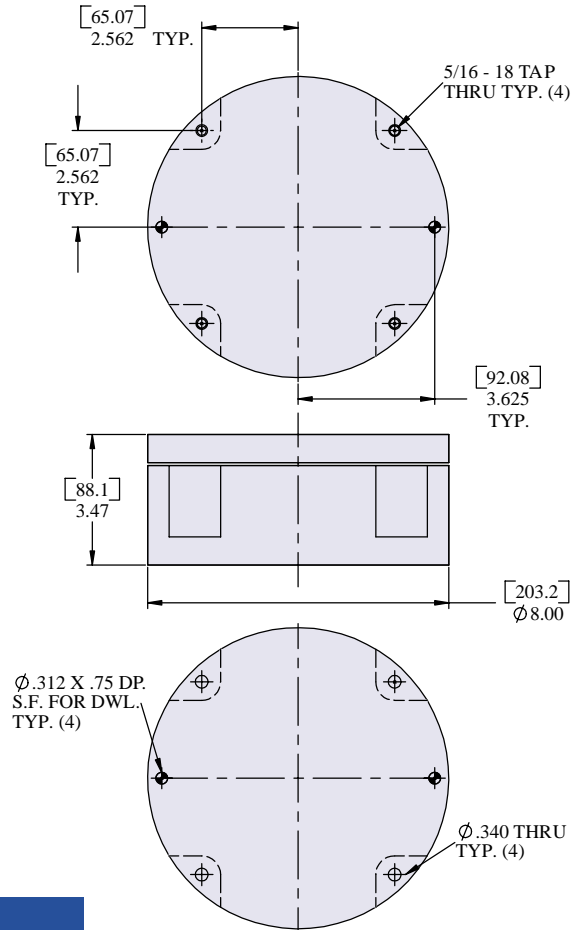

1822 Load Data

