

MODELS 1719 Spring-Loaded 1819 Pneumatic

Specifications

Unit Weight 2.5 lbs.
 Maximum Lateral Misalignment ±0.10 in.
 Maximum Rotary Misalignment..... ±5°

Model #	Unit Horizontal		Unit Vertical	
	Max Payload lb	Torsional Resistance in-lb	Max Payload lb	Torsional Resistance in-lb
1719 A	21.8	22.0	7.3	7.2
1719 B	50.8	55.0	17.1	16.6
1719 C	65.9	71.0	22.1	21.6
1819 S	100.0 @90 psi	91.3 @90 psi	33.6 @60 psi	30.7 @60 psi

To find Total Payload:

SL = Static Payload = Mass of all tooling & parts
 DL = Dynamic Payload = Max. Accel/Decel (G's) x SL
 TL = Total Payload = SL + DL

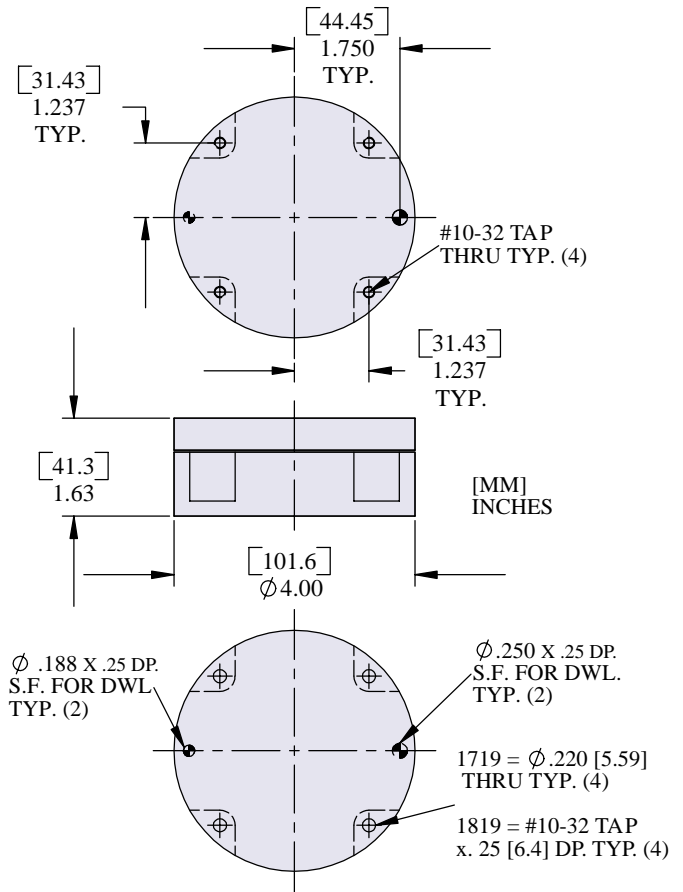

1819 Load Data

