

MODELS 1720 Spring-Loaded 1820 Pneumatic

Specifications

Unit Weight 6.5 lbs.
 Maximum Lateral Misalignment ± 0.10 in.
 Maximum Rotary Misalignment..... $\pm 5^\circ$

Model #	Unit Horizontal		Unit Vertical	
	Max Payload lb	Torsional Resistance in-lb	Max Payload lb	Torsional Resistance in-lb
1720 A	24.4	29.0	11.0	13.1
1720 B	47.0	56.0	14.1	16.8
1720 C	76.4	90.0	22.9	27.3
1820 ZR	149.1 @90 psi	172.2 @90 psi	44.7 @90 psi	51.7 @90 psi

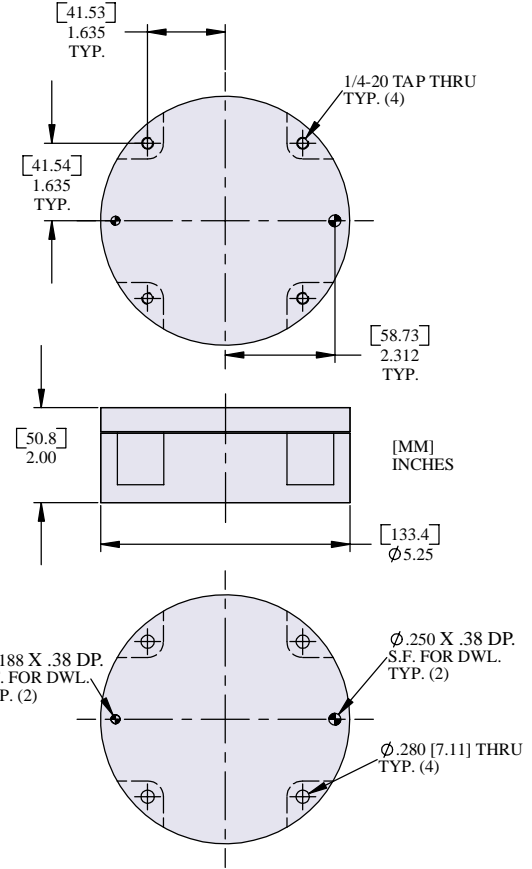

To find Total Payload:

SL = Static Payload = Mass of all tooling & parts
 DL = Dynamic Payload = Max. Accel/Decel (G's) x SL
 TL = Total Payload = SL + DL

